

PERMIT  
 CITY OF NAPOLEON, OHIO - BUILDING DEPARTMENT  
 255 West Riverview Avenue, Napoleon, Ohio 43545 - (419) 592-4010

Permit No. 3624 Issued 08/10/95  
 Job Location 1125 Westmont  
 Lot 33 Gerken/Hoeffel 3rd Add.  
 Issued by Brent N. Damman  
 Owner Corinne March 592-8572  
 Address 809 W. Main St.  
 Agent Bock/Buehrer 592-0825  
 Address 1227 Dodd St. Napoleon, OH  
 Use Type - Residential X  
 Other - Describe \_\_\_\_\_  
 No. Dwelling Units \_\_\_\_\_  
 New X Replacement \_\_\_\_\_  
 Add'n. \_\_\_\_\_ Alter \_\_\_\_\_ Remodel \_\_\_\_\_  
 Mixed Occupancy \_\_\_\_\_  
 Change of Occupancy \_\_\_\_\_  
 Estimated Cost \$ 140,000.00

FEES	BASE	PLUS	TOTAL
<input checked="" type="checkbox"/> Building	\$ 9.00	\$ 264.80	\$ 273.80
<input checked="" type="checkbox"/> Electrical	\$ 15.00	\$ 75.00	\$ 90.00
<input checked="" type="checkbox"/> Plumbing	\$ 9.00	\$ 36.00	\$ 45.00
<input checked="" type="checkbox"/> Mechanical	\$ 18.00	\$ 6.00	\$ 24.00
<input type="checkbox"/> Demolition	\$ _____	\$ _____	\$ _____
<input type="checkbox"/> Zoning	\$ _____	\$ _____	\$ _____
<input type="checkbox"/> Sign	\$ _____	\$ _____	\$ _____
<input checked="" type="checkbox"/> Water Tap	\$ 650.00	\$ _____	\$ 650.00
<input type="checkbox"/> Sew. Insp.	\$ _____	\$ _____	\$ _____
<input checked="" type="checkbox"/> Sewer Tap	\$ 123.24	\$ _____	\$ 123.24
<input checked="" type="checkbox"/> Temp. Water	\$ 5.00	\$ _____	\$ 5.00
<input checked="" type="checkbox"/> Temp. Elec.	\$ 10.00	\$ _____	\$ 10.00
TOTAL FEES.....			\$1221.04
LESS FEES PAID.....			\$ _____
BALANCE DUE.....			\$ _____

**ZONING INFORMATION**

district <b>A</b>	lot dimensions <b>85 x 120</b>	area <b>10200</b>	front yd <b>30'</b>	side yd <b>10'</b>	rear yd <b>15'</b>
max hgt <b>35'</b>	no pkg spaces <b>2 per</b>	no ldg spaces	max cover <b>35%</b>	petition or appeal req'd	date appr

**WORK INFORMATION**

Size: Length 64' Width 50' Stories 1 Ground Floor Area 1700  
 Height 16' Building Volume (for Demo. Permit) \_\_\_\_\_

Electrical: \_\_\_\_\_  
 Plumbing: \_\_\_\_\_  
 Mechanical: \_\_\_\_\_

Additional Information: New Home (Sun Room 146 Sq Ft)

Date \_\_\_\_\_ Applicant Signature \_\_\_\_\_

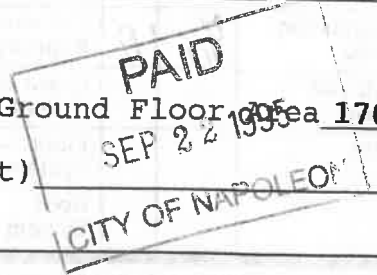

# INSPECTION RECORD

	UNDERGROUND			ROUGH-IN						FINAL		
	Type	Date	By	Type	Date	By	Type	Date	By	Type	Date	By
<b>PLUMBING</b>	Building Drains			Drainage, Waste & Vent Piping			Indirect Waste			Drainage, Waste & Vent Piping		
	Water Piping									Backflow Prevention		
	Building Sewer			Water Piping			Condensate Lines			Water Heater		
	Sewer Connection									FINAL APPROVAL	12/27	BD
<b>MECHANICAL</b>	Refrigerant Piping			Refrigerant Piping			Chimney(s)			Grease Exhaust System		
				Duct Furnace(s)			Fire Dampers			Air Cond. Unit(s)		
	Ducts/Plenums			Ducts/Plenums			<input type="checkbox"/> Radiant Htr(s) <input type="checkbox"/> Unit Htr(s)			Refrigeration Equipment		
				Duct Insulation			Pool Heater			Furnace(s)		
				Combustion Products Vents			Ventilation <input type="checkbox"/> Supply <input type="checkbox"/> Exhst.			FINAL APPROVAL	12/27	BD
<b>ELECTRICAL</b>	Conduits & or Cable			Conduits/Cable			<input type="checkbox"/> Range <input type="checkbox"/> Dryer			Temp Service Temp Lighting		
	Grounding & or Bonding			Rough Wiring			<input type="checkbox"/> Generator(s) <input type="checkbox"/> Motors			Fixtures Lampholders		
	Floor Ducts Raceways			Service Panel Switchboard			<input type="checkbox"/> Water Htr <input type="checkbox"/> Welder			Signs		
	Service Conduit			Busways Ducts			<input type="checkbox"/> Heaters <input type="checkbox"/> Heat Cable			Electric Mtr. Clearance		
	Temporary Power Pole			Subpanels			<input type="checkbox"/> Duct Htr(s) <input type="checkbox"/> Furnace(s)			FINAL APPROVAL	12/27	BD
<b>BUILDING</b>	Location, Set-backs, Esmt(s)	8/15	BD	Exterior Wall Construction	9/29	BD	Roof Covering Roof Drainage	11/4	BD	Smoke Detector		
	Excavation	8/15	BD				Exterior Lath			Demolition (sewer cap)		
	Footings & Reinforcing	8/15	BD				<input type="checkbox"/> Interior Lath <input type="checkbox"/> Wallboard					
	Floor Slab			Interior Wall Construction	11/6	BD	Fire Wall(s)			Building or Structure		
	Foundation Walls	8/15	BD	Columns & Supports			Fireplace Chimney					
	Sub-soil Drain			Crawl Space <input type="checkbox"/> Vent <input type="checkbox"/> Access	11/6	BD	Attic <input type="checkbox"/> Vent <input type="checkbox"/> Access					
	Piles			Floor System(s)	7/29	BD				FINAL APPROVAL BLDG. DEPT.	12/27	BD
				Roof System	11/6	BD	Special Insp Reports Rec'd			Certificate of Occupancy Issued	12/27	BD
<b>ADDITIONAL</b>	INSPECTIONS, CORRECTIONS, ETC.						INSPECTIONS, CORRECTIONS, ETC.					

# METER YOKE RELEASE

This document is for the release of one (1) Water Meter Yoke for Residential water service lines.

RELEASE NO. 179  
PERMIT NO. 3624 ISSUED 11-29-95  
JOB LOCATION 1125 Westmont  
 - Inside City Limits      ( ) - Outside City Limits  
ISSUED BY BND  
OWNER Corinne March  
ADDRESS 809 W. Main Map  
CONTRACTOR Damman P+H  
ADDRESS N-033 Co. Rd. 17D  
CONTRACTOR'S PHONE NO. 758-3116  
WATER TAP SIZE:  = 1"      ( ) = 1-1/2"      ( ) = 2"  
WATER METER s# \_\_\_\_\_  
 - New Dwelling      ( ) - Existing Dwelling  
( ) - Lawn Meter

Water Service Line to be Type (K) Copper or (CTS) Polyethelene Tubing of one inch (1") minimum.

Watts No. 7 Dual check required ( ) = Yes       = No

Water Meter Yoke installation is subject to the following conditions:

- 1.) Must be located in an accessible area.
- 2.) Must be in an area not subject to freezing temperatures.
- 3.) Must be eighteen inches (18") above floor level, not in crawl spaces.
- 4.) Must comply with the mounting criteria and clearances as set forth in DRAWING #04403901.



# City of NAPOLEON, OHIO

255 RIVERVIEW AVENUE, P.O. BOX 151  
NAPOLEON, OHIO 43545-0151  
(419) 592-4010



December 20th, 1995

Ms. Corinne March  
809 W. Main  
Napoleon, Ohio 43545

Mayor  
Robert G. Heft

Members of Council  
John E. Church, President  
Michael J. DeWit  
James Hershberger  
Sarah Peper  
Terri A. Williams  
Travis B. Sheaffer  
Dennis Filgor

City Manager  
Marc S. Gerken

Finance Director  
Gregory J. Heath

Law Director  
David M. Grahn

City Engineer  
Adam C. Hoff, P.E.

Dear Ms. March

This morning I was ask to perform a final plumbing inspection at your new home located at 1125 Westmont. While I was inspecting the plumbing I noticed that you have developed another dwelling quarters in the basement of your new home. This was not shown on the original plans submitted to my office.

Therefore your contractor will need to submit a set of plans showing the additional rooms developed in the basement along with the application for a building permit for said work.

Also please be aware that each sleeping area must have a means of egress for fire escape. I would also make you aware that the second dwelling quarters you have developed in the basement may only be used for the keeping of persons in your immediate family and cannot be used as a rental apartment.

This letter will also serve as a temporary occupancy permit for the **GROUND FLOOR ONLY** and in no way can the basement be occupied or used until such time plans are submitted and permits issued for the work that was performed.

If you have questions regarding this notice please call at 592-4010.

Sincerely

*Brent N Damman*  
Brent N Damman  
Building & Zoning  
Administrator

cc. Mock/Buehrer Builders

C:\AMPRO\DOC\BLDCODE\MARCH



**APPLICATION FOR**

Residential, Building, Electrical, Plumbing, Mechanical, and Demolition Permit

FROM - The City of Napoleon, Ohio, Building Department

255 West Riverview Avenue; P.O. Box 151; Napoleon, Ohio 43545 - Telephone (419) 592-4010

ENTRY NO. \_\_\_\_\_

PERMIT NO. 3624 ISSUED 8-10-95

JOB LOCATION 1125 Westmont

LOT 33 See Plat 12/20/91 Sub  
(Subdivision or Legal Description)

ISSUED BY BND  
(Building Official)

OWNER Corinne March PHONE 592-8572

ADDRESS 809 W. Main  
0401 Buckeye Napoleon

AGENT Mock/Buehrer PHONE 592-0825

ADDRESS 1227 Dodd Napoleon

USE:  Residential  Commercial  Industrial  
 Other \_\_\_\_\_

WORK:  New  Addition  Replacement  Remodel

ESTIMATED COST = \$ 140,000.00

	<u>Base</u>	<u>Plus</u>	<u>Total</u>
<input checked="" type="checkbox"/> Building	\$ <u>9.00</u>	\$ <u>264.80</u>	\$ <u>273.80</u>
<input checked="" type="checkbox"/> Electrical	\$ <u>15.00</u>	\$ <u>75.00</u>	\$ <u>90.00</u>
<input checked="" type="checkbox"/> Plumbing	\$ <u>9.00</u>	\$ <u>36.00</u>	\$ <u>45.00</u>
<input checked="" type="checkbox"/> Mechanical	\$ <u>18.00</u>	\$ <u>6.00</u>	\$ <u>24.00</u>
<input type="checkbox"/> Demolition	\$ _____	\$ _____	\$ _____
<input type="checkbox"/> Zoning	\$ _____	\$ _____	\$ _____
<input type="checkbox"/> Sign	\$ _____	\$ _____	\$ _____
<input checked="" type="checkbox"/> Water Tap	\$ <u>650.00</u>	\$ _____	\$ <u>650.00</u>
<input checked="" type="checkbox"/> Sewer Tap	\$ <u>123.24</u>	\$ _____	\$ <u>123.24</u>
<input checked="" type="checkbox"/> Temp Water	\$ <u>5.00</u>	\$ _____	\$ <u>5.00</u>
<input checked="" type="checkbox"/> Temp Elec.	\$ <u>10.00</u>	\$ _____	\$ <u>10.00</u>

Additional Plan Review: Structure \_\_\_\_\_ Hours \_\_\_\_\_  
Electric \_\_\_\_\_ Hours \_\_\_\_\_

TOTAL FEES . . . . .	\$ <u>1221.04</u>
Less Fees Paid . . . . .	\$ _____
BALANCE DUE . . . . .	\$ <u>1221.04</u>

**ZONING INFORMATION**

District	Lot Dimensions	Area	Front Yard	Side Yard	Rear Yard
A	85x120	10200	30'	10'	15'

Max Height	No. Pkg. Spaces	No. Ldg. Spaces	Max Cover	Petition or Appeal Required-Date
35'	2 pcr		35%	

**WORK INFORMATION**

Building: Ground Floor Area 1700 sq. ft. Basement Floor Area 1700 sq. ft.  
Garage Floor Area 576 sq. ft. 2nd Floor Area \_\_\_\_\_ sq. ft. Other Sun Room 146 sq. ft.  
Size: Length 64' Width 50' Stories 1 Height 16'  
Building Volume (for Demolition Permit) \_\_\_\_\_ cubic feet  
Description of Work: New Home

**ELECTRICAL:** Contractor \_\_\_\_\_ Phone \_\_\_\_\_  
Address \_\_\_\_\_ ESTIMATED COST = \$ \_\_\_\_\_

**Type of Work:** ( ) New ( ) Service Change ( ) Rewiring ( ) Add'l Wiring TEMPORARY ELEC. REQUIRED - ( ) Yes ( ) No  
Size of Service 200 Underground  Overhead \_\_\_\_\_ Number of New Circuits 25

**Description of Work:** \_\_\_\_\_

**PLUMBING:** Contractor \_\_\_\_\_ Phone \_\_\_\_\_  
Address \_\_\_\_\_ ESTIMATED COST = \$ \_\_\_\_\_

WATER TAP REQUIRED - ( ) Yes ( ) No Size \_\_\_\_\_ Type of Pipe \_\_\_\_\_ Water Dist. Pipe \_\_\_\_\_

SANITARY SEWER TAP REQUIRED - ( ) Yes ( ) No Size \_\_\_\_\_ Type of Pipe \_\_\_\_\_ Dr. Waste Vt. Pipe \_\_\_\_\_

STREET SEWER TAP REQUIRED - ( ) Yes ( ) No Type of Pipe \_\_\_\_\_ STREET TO BE OPENED - ( ) Yes ( ) No  
Main Building Drain Size = \_\_\_\_\_ Main Vent Pipe Size = \_\_\_\_\_

**LIST NUMBER OF PLUMBING FIXTURES BELOW:**

Water Closets = 3 Bathtubs = 2 Showers = \_\_\_\_\_ Lavatories = 3 Kitchen Sinks = 1 Disposal = 1  
Clothes Washer = 1 Floor Drains = \_\_\_\_\_ Dishwasher = 1 Other \_\_\_\_\_ Total = 12

**Description of Work:** \_\_\_\_\_

**MECHANICAL:** Contractor \_\_\_\_\_ Phone \_\_\_\_\_  
Address \_\_\_\_\_ ESTIMATED COST = \$ \_\_\_\_\_

HEATING SYSTEM -  Forced Air ( ) Gravity ( ) Hot Water ( ) Steam ( ) Unit Heaters ( ) Radiant ( ) Baseboard

TYPE OF FUEL - ( ) Electric  Natural Gas ( ) Propane ( ) Wood ( ) Coal ( ) Solar ( ) Geothermal Other \_\_\_\_\_

NUMBER OF HEAT ZONES = \_\_\_\_\_ HOT WATER - ( ) One (1) Pipe ( ) Two (2) Pipes ( ) Series Loop

ELECTRIC HEAT - Number of Circuits \_\_\_\_\_ Number of Furnaces 1 Number of Hot Air Runs 13

Number of Hot Water Radiators \_\_\_\_\_ Total Heat Loss \_\_\_\_\_ Rated Capacity of Furnace/Boiler \_\_\_\_\_

LOCATION OF HEATING UNITS - ( ) Crawl Space ( ) Floor Level ( ) Attic ( ) Suspended ( ) Roof ( ) Outside

**Description of Work:** \_\_\_\_\_

**DRAWINGS REQUIRED:** All applications must be accompanied by two (2) complete sets of Drawings including Site Plans, Foundation Plans, Floor Plans, Structural Framing Plans, Exterior Elevations, Section and Details, Stair Details, Electrical Layout, Plumbing Isometric, Heating Layout, etc. All Plans shall be drawn to scale, show all existing structure on the Site Plans, and show electric panel and furnace locations.

**READ AND SIGN BELOW:** The undersigned hereby makes application for a Permit for all work described herein and agrees to complete the work in strict accordance with all applicable provisions of the current edition of the C.A.B.O. Building Code, the Napoleon Building and Zoning Codes, the Napoleon Engineering Department Rules and Regulations, Standard Specifications and other pertinent sections of the Napoleon Code of Ordinances.

Signature of Applicant \_\_\_\_\_ Date \_\_\_\_\_



WATER TAPPING PERMIT  
 issued by  
 The Napoleon Water Distribution Department  
 255 West Riverview Ave. Napoleon, Ohio 43545 Ph. 592-4010

Permit No. W-0599 Issued \_\_\_\_\_ Received of \_\_\_\_\_ (\$ \_\_\_\_\_) .00

(Charge for tapping permit to supply water service to) Lot No. \_\_\_\_\_ Sub Div. \_\_\_\_\_

Street No. \_\_\_\_\_ Tap Size \_\_\_\_\_ \* Cost \$ \_\_\_\_\_ .00 Plumber \_\_\_\_\_

Date completed \_\_\_\_\_ Approved by W. E. Mantugh water distribution dept. \_\_\_\_\_ finance director

Name \_\_\_\_\_ Size of tap 1" Date 10-11-95 Street and No. 1125 Westmont

Old Tap No. \_\_\_\_\_ New Tap No. 9574 Size and Kind of Main 8" C-900

Location of Main 8' South of South CURB Depth of Main 5'

Distance from Hydrant/Valve 209' East of Hyd 454 Distance to Curb Stop from Corp. 8'

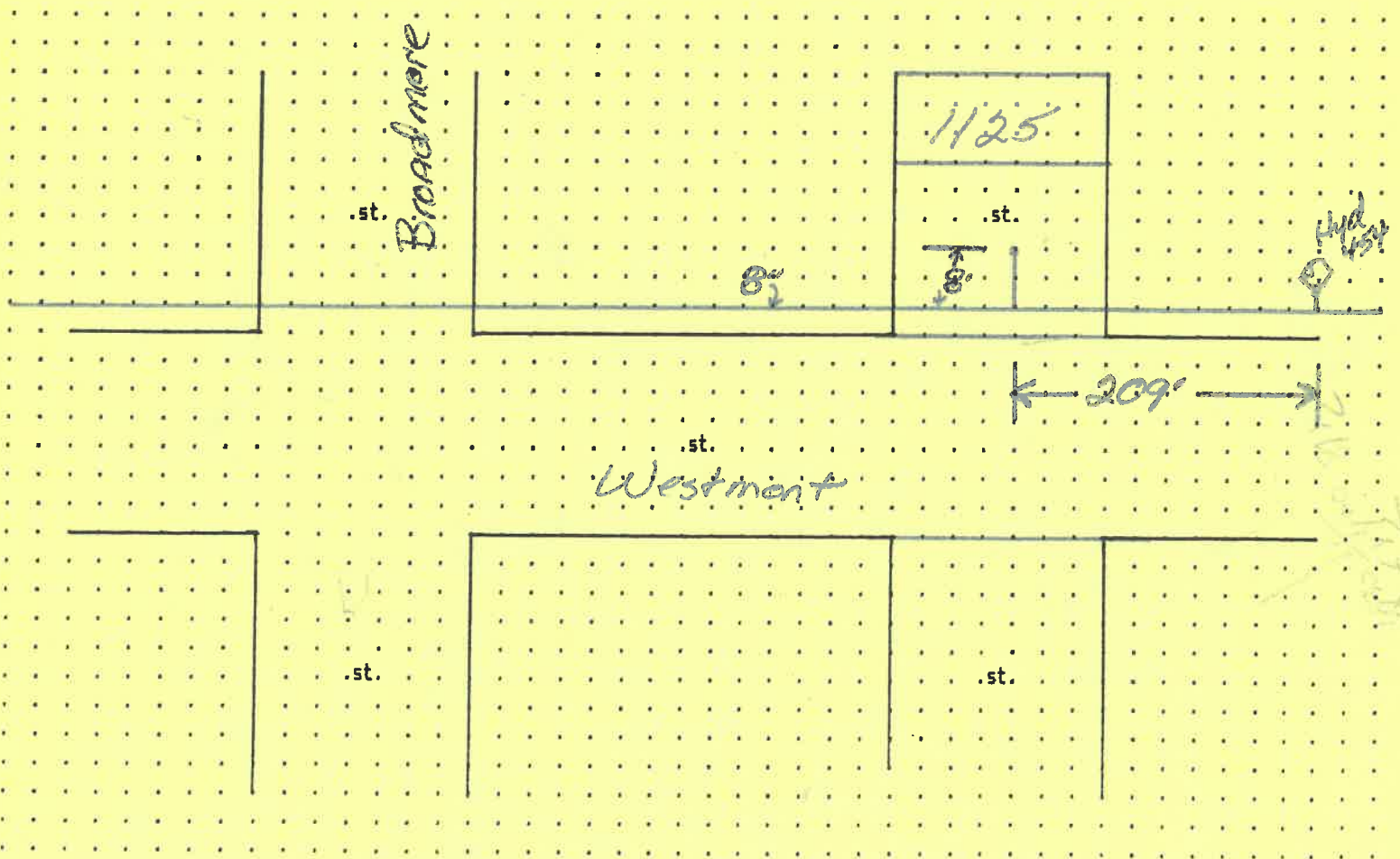



1125 Westmont  
9-15-95  
Roger + Tom Miller  
Burkholder const.

